

AUTO XS®

CAR ACCESSORIES

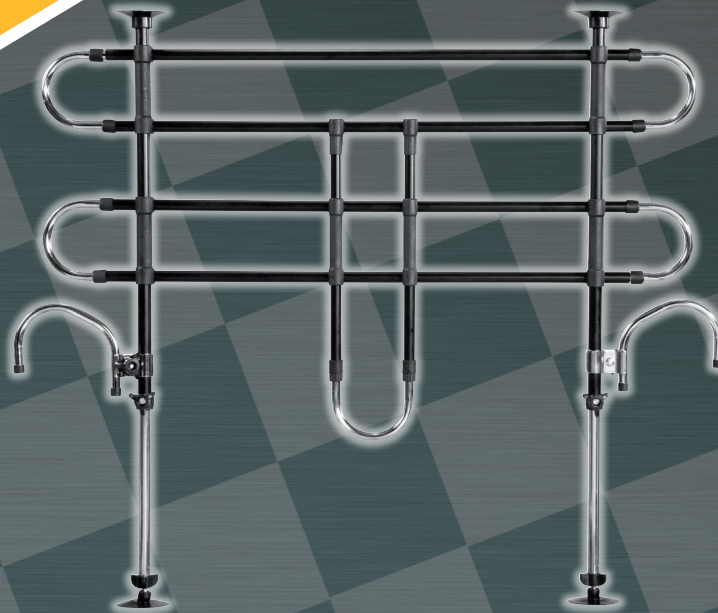

UNIVERSAL DOG GUARD

USER GUIDE

After Sales Support

Now you have purchased an AUTO XS® product you can rest assured in the knowledge that as well as your 3 year parts and labour guarantee you have the added peace of mind of dedicated helplines and web support.

AFTER SALES SUPPORT



GB 0208 779 68 31 IRE 01 44 33 630



www.ovibell-int.de

MODEL NUMBER: 4693

Contents

02	Introduction
03	Pack Contents
04	Assembly and Installation
04	Before you begin
05/06	Assembly
07	Installation
08	Maintenance

Introduction

2

Congratulations on choosing to buy an AUTO-XS™ product. By doing so you now have the assurance and peace of mind that comes with purchasing a product made by one of Europe's leading manufacturers.

We hope you will enjoy using your purchase for many years to come.

AFTER SALES SUPPORT



GB

0208 779 68 31

IRE

01 44 33 630



www.ovibell-int.de

MODEL NUMBER: 4693

2

Pack Contents

3

- A. Upper cross bars
- B. Lower cross bars
- C. 2 Seat back fixing hooks
- D. Telescopic legs
- E. Central U-tube
- F. 2 Rubber tops
- G. 2 Rubber feet
- H. 8 Phillips screws
- I. 8 Washers

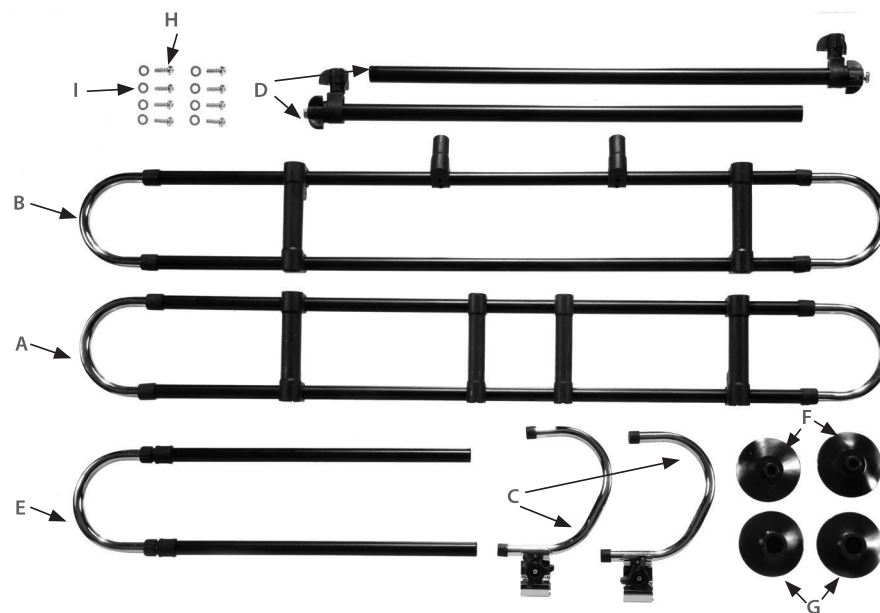

AFTER SALES SUPPORT



GB 0208 779 68 31
IRE 01 44 33 630



www.ovibell-int.de

MODEL NUMBER: 4693

3

Assembly and Installation

4

Before you begin

Read through this manual completely and familiarise yourself with all of the dog guard's features and the assembly procedure before you begin.

Unpack all of the components, lay them out before you and check that the delivery is complete.

Do not dispose of the packaging until you are sure that you have all of the parts.

Tools required:

The dog guard comes partly assembled. The only tool required is a Phillips screwdriver.

AFTER SALES SUPPORT



GB

0208 779 68 31

IRE

01 44 33 630



www.ovibell-int.de

MODEL NUMBER: 4693

4

Assembly

5

The dog guard must be assembled as shown in the diagram below.

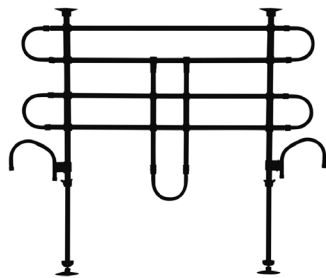

Proceed as follows to assemble the dog guard.

Lay out both the upper and lower cross bars (A & B) and the seat fixing hooks (C) in front of you. Slot the telescopic legs (D) through the plastic fittings. If you wish to use the seat fixing hooks attach these to the telescopic legs below the lower cross bars.

Slot the central rods through the plastic fittings in the centre of the cross bars.

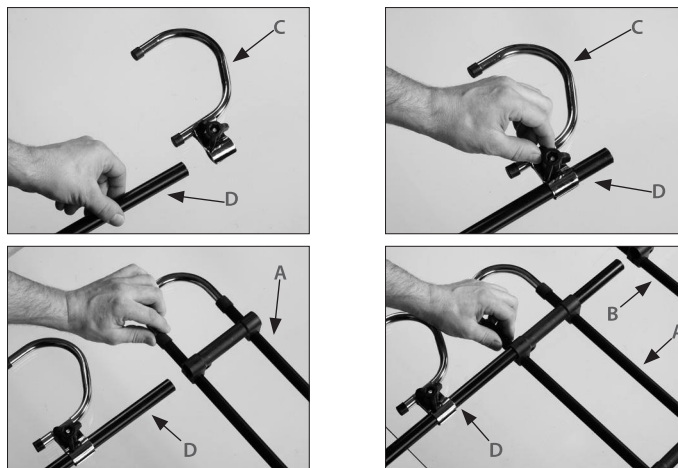

AFTER SALES SUPPORT



GB 0208 779 68 31
IRE 01 44 33 630



www.ovibell-int.de

MODEL NUMBER: 4693

5

Assembly

6

1. The central rods are fitted with a threaded clamping sleeve and sleeve nut to hold the central U-tube in place.
 - Unscrew the sleeve nut and slide the U-tube (E) into the central rods.
 - Re-tighten the sleeve nuts to fix the central U-tube (E) in place.
 - Using a Phillips screwdriver, drive the screws supplied into the holes provided in the plastic fittings as illustrated.

Do not tighten the screws fully at this stage.

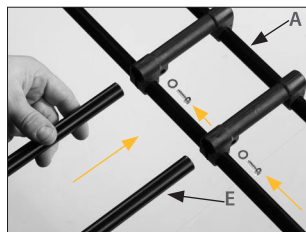

2. Fix the rubber tops (F) to the top of each telescopic leg (D).

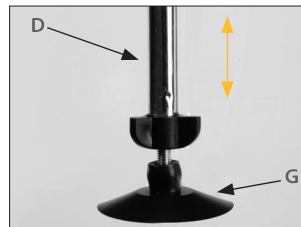
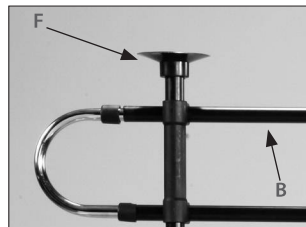

3. A bolt is located at the end of the telescopic section. Extend the bolt approximately 2-3 centimetres and fit the rubber foot over the bolt as illustrated.

TIP: The rubber foot fits very tightly onto the bolt. You may wish to soften the rubber foot slightly by immersing it in warm water first.

AFTER SALES SUPPORT



GB 0208 779 68 31
IRE 01 44 33 630



www.ovibell-int.de

MODEL NUMBER: 4693

6

Installation

7

After completing assembly as described above the dog guard can be installed in your car.

- Remove the parcel shelf.
 - If you wish to use the seat back fixing hooks, hook these over the back seat of your car.
1. Loosen the telescopic leg (D) fixing screws and extend the telescopic section so that the dog guard fits your car's boot between the roof and the floor.
 - Subsequently re-tighten the fixing screws.
 - The dog guard must be wedged very tightly between your car's roof and the floor.

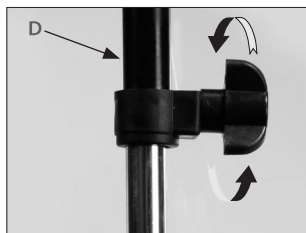

2. To achieve a tight fit, rotate the plastic grips at the bottom of the telescopic leg section anti-clockwise as illustrated. This drives out the bolt and forces the rubber foot against the floor.

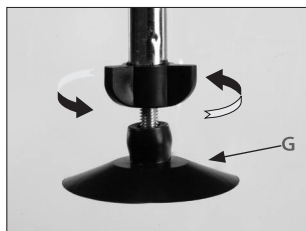

AFTER SALES SUPPORT



GB

0208 779 68 31

IRE

01 44 33 630



www.ovibell-int.de

MODEL NUMBER: 4693

7

3. Now adjust the position of the cross bars and the central rods to suit car.
Tighten the screws in the plastic fittings.

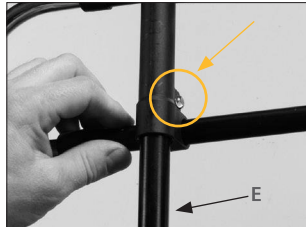

Maintenance

8

The dog guard requires very little maintenance but should be cleaned regularly with a damp, soapy cloth.

Do not use abrasive cleaning agents.

Check regularly that the dog guard fits tightly and adjust if necessary.

Service Adresses

SPECIALLY PRODUCED FOR ALDI STORES BY:
OVIBELL GMBH & CO. KG
STEINESHOFFWEG 2
45479 MÜLHEIM AN DER RUHR
GERMANY
Visit us at www.aldi.com

AFTER SALES SUPPORT



GB

0208 779 68 31

IRE

01 44 33 630



www.ovibell-int.de

MODEL NUMBER: 4693

8